

File Number
Related File Number
Pre-consultation Meeting
Application Submitted
Complete Application
Public Notice Sign

BNPL2017121
—
Mar 22/17
June 23/17

SPRT Meeting
Application Fee
Conservation Authority Fee
OSSD Form Provided
Planner
PAC Meeting

\$1842
\$231.65
new system being installed
Alisha

A. Applicant Information

Name of Owner HEATHER JO CAUSYN

Address 417 Queensway West

Town and Postal Code Simcoe, ON N3Y2N5

Phone Number 519-909-9909

Cell Number _____

Email _____

Name of Applicant _____

Address Same as owner

Town and Postal Code _____

Phone Number _____

Cell Number _____

Email _____



Name of Agent Thomas A. Cline
Address 23 Argyle St., P. O. Box 548
Town and Postal Code Simcoe, ON. N3Y 4N5
Phone Number 519-428-0170
Cell Number _____
Email tcline@cobbjones.ca

Name of Engineer N/A
Address _____
Town and Postal Code _____
Phone Number _____
Cell Number _____
Email _____

Please specify to whom all communications should be sent. Unless otherwise directed, all correspondence, notices, etc., in respect of this application will be forwarded to the applicant noted above.

- ☐ Applicant
☒ Agent
☐ Owner

Names and addresses of any holder of any mortgagees, charges or other encumbrances on the subject lands:

Royal Bank, 55 Norfolk St. S., Simcoe, ON. N3Y 2W1



B. Location, Legal Description and Property Information

1. Property Assessment Roll Number: 3310 – 403-025-01200

Legal Description (include Geographic Township, Concession Number, Lot Number, Block Number and Urban Area or Hamlet):

Pt. L. 3, Conc. 14, former Township of Windham, Simcoe

Municipal Civic Address (911 Number): 417 Queensway W., Simcoe, ON

Present Official Plan Designation(s): Hazard Land *Provincially Significant Wetland, commercial*

Present Zoning: Hazard – CS Commercial Service, PSW

2. Is there a special provision or site specific zone on the subject lands?

NO

3. The date the subject lands was acquired by the current owner: 2000

4. Present use of the subject lands:

Residential – Single Family Dwelling

5. Please describe **all existing** buildings or structures on the subject lands and whether they are to be retained, demolished or removed. If retaining the buildings or structures, please describe the type of buildings or structures, and illustrate the setback, in metric units, from front, rear and side lot lines, ground floor area, gross floor area, lot coverage, number of storeys, width, length, height, etc. on your attached sketch which must be included with your application:

Single Family Dwelling, wood sided outbuilding, wood shed as per sketch attached

6. If known, the date existing buildings or structures were constructed on the subject lands: Unknown



7. If an addition to an existing building is being proposed, please explain what will it be used for (e.g. bedroom, kitchen, bathroom, etc.). If new fixtures are proposed, please describe.

N/A _____

8. Please describe **all proposed** buildings or structures/additions on the subject lands. Describe the type of buildings or structures/additions, and illustrate the setback, in metric units, from front, rear and side lot lines, ground floor area, gross floor area, lot coverage, number of storeys, width, length, height, etc. on your attached sketch which must be included with your application:

No change is proposed _____

9. If known, the date the proposed buildings or structures will be constructed on the subject lands:

N/A _____

10. Are any existing buildings on the subject lands designated under the *Ontario Heritage Act* as being architecturally and/or historically significant? Yes ☐ No ☐

If yes, identify and provide details of the building:

NO _____

11. If known, the length of time the existing uses have continued on the subject lands:

Pre-1950

12. Existing use of abutting properties:

To the north – hazard land; to the south – commercial; to the east – commercial; to the west – hazard and commercial

13. Are there any easements or restrictive covenants affecting the subject lands?

☐ Yes ☒ No If yes, describe the easement or restrictive covenant and its effect:

14. Does the requested amendment alter all or any part of the boundary of an area of settlement in the municipality or implement a new area of settlement in the municipality? ☐ Yes ☒ No If yes, describe its effect:

15. Does the requested amendment remove the subject land from an area of employment? ☐ Yes ☒ No If yes, describe its effect:



C. Purpose of Development Application

Note: Please complete all that apply.

1. Please explain what you propose to do on the subject lands/premises which makes this development application necessary:

To sever off existing single family dwelling + merge parking with commercial property to south

2. Description of land intended to be severed in metric units:

Frontage: none

Depth: irregular 109.69 m

Width: variable - rear 69.87 m.

Lot Area: 6818.4 m²

Present Use: Residential / parking

Proposed Use: parking

3. Name of person(s), if known, to whom lands or interest in lands to be transferred, leased or charged (if known):

N/A

4. List all properties in Norfolk County, which are owned and farmed by the applicant and involved in the farm operation:

Owners Name: N/A

Roll Number: _____

Total Acreage: _____

Workable Acreage: _____

Existing Farm Type: (i.e., corn, orchard etc) _____

Dwelling Present?: ☐ Yes ☐ No If yes, year dwelling built _____



Owners Name: N/A
Roll Number: _____
Total Acreage: _____
Workable Acreage: _____
Existing Farm Type: (i.e., corn, orchard etc) _____
Dwelling Present?: ☐ Yes ☐ No If yes, year dwelling built _____

Owners Name: N/A
Roll Number: _____
Total Acreage: _____
Workable Acreage: _____
Existing Farm Type: (i.e., corn, orchard etc) _____
Dwelling Present?: ☐ Yes ☐ No If yes, year dwelling built _____

Owners Name: N/A
Roll Number: _____
Total Acreage: _____
Workable Acreage: _____
Existing Farm Type: (i.e., corn, orchard etc) _____
Dwelling Present?: ☐ Yes ☐ No If yes, year dwelling built _____

Owners Name: N/A
Roll Number: _____
Total Acreage: _____
Workable Acreage: _____
Existing Farm Type: (i.e., corn, orchard etc) _____
Dwelling Present?: ☐ Yes ☐ No If yes, year dwelling built _____

Note: If additional space is needed please attach a separate sheet.

5. Please explain why it is not possible to comply with the provision(s) of the Zoning By-law/and or Official Plan:

N/A

6. Does the requested amendment delete a policy of the Official Plan? ☐ Yes ☒ No
If yes identify the policy to be deleted:

7. Does the requested amendment change or replace a policy in the Official Plan?
☐ Yes ☒ No If yes, identify the policy to be changed or replaced, also include the proposed text of the policy amendment (if additional space is required, please attach a separate sheet):

8. Site Information

Existing

Proposed

Please indicate unit of measurement i.e. m, m² or % etc.

Lot frontage	<u>N/A</u> _____	<u>N/A</u> _____
Lot depth	_____	_____
Lot width	_____	_____
Lot area	_____	_____
Lot coverage	_____	_____
Front yard	_____	_____
Rear yard	_____	_____
Left Interior side yard	_____	_____
Right Interior side yard	_____	_____
Exterior side yard (corner lot)	_____	_____
Landscaped open space	_____	_____
Entrance access width	_____	_____
Exit access width	_____	_____
Size of fencing or screening	_____	_____
Type of fencing	_____	_____

9. Building Size

Number of storeys	<u>N/A</u> _____	<u>N/A</u> _____
Building height	_____	_____
Total ground floor area	_____	_____
Total gross floor area	_____	_____
Total useable floor area	_____	_____

10. Off Street Parking and Loading Facilities

Number of off street parking spaces	<u>N/A</u> _____	<u>N/A</u> _____
Number of visitor parking spaces	_____	_____
Number of accessible parking spaces	_____	_____
Number of off street loading facilities	_____	_____

11. Multiple Family Residential

Number of buildings existing: N/A

Number of buildings proposed: _____

Is this a conversion or addition to an existing building? ☐ Yes ☐ No

If yes, describe: _____

Type	Number of Units	Floor Area per Unit in m ²
Bachelor	_____	_____
One bedroom	_____	_____
Two bedroom	_____	_____
Three bedroom	_____	_____
Group townhouse	_____	_____
Stacked townhouse	_____	_____
Street townhouse	_____	_____

Other facilities provided (e.g. play facilities, underground parking, games room, swimming pool etc.): _____

12. Commercial/Industrial Uses

Number of buildings existing: N/A

Number of buildings proposed: _____

Is this a conversion or addition to an existing building? ☐ Yes ☐ No

If yes, describe:

Indicate the gross floor area by the type of use (e.g. office, retail, storage, etc.):



Seating Capacity (for assembly halls, etc.): _____

Total number of fixed seats: _____

Describe the type of business(es) proposed: _____

Total number of staff proposed initially: _____

Total number of staff proposed in five years: _____

Maximum number of staff on the largest shift: _____

Is open storage required: ☐ Yes ☐ No

Is a residential use proposed as part of, or accessory to commercial/industrial use? ☐

Yes ☐ No ☐ If yes please describe:

13. Institutional

Describe the type of use proposed: N/A _____

Seating capacity (if applicable): _____

Number of beds (if applicable): _____

Total number of staff proposed initially: _____

Total number of staff proposed in five years: _____

Maximum number of staff on the largest shift: _____

Indicate the gross floor area by the type of use (e.g. office, retail, storage, etc.):

14. Describe Recreational or Other Use(s)

N/A _____

1. Has there been an industrial or commercial use on the subject lands or adjacent lands? ☒ Yes ☐ No ☐ Unknown

Retail on adjacent lands; Residential on proposed severed lands _____

4. Provide the information you used to determine the answers to the above questions:

Historical Use _____

-

E. Provincial Policy

1. Is the requested amendment consistent with the provincial policy statements issued under subsection 3(1) of the *Planning Act*, R.S.O. 1990, c. P. 13? ☒ Yes ☐ No

If no, please explain:

2. Have the subject lands been screened to ensure that development or site alteration will not have any impact on the habitat for endangered or threatened species further to the provincial policy statement subsection 2.1.7? ☐ Yes ☒ No

If no, please explain:

No changes whatsoever proposed

3. Have the subject lands been screened to ensure that development or site alteration will not have any impact on source water protection? ☐ Yes ☒ No

4. Note: If in an area of source water WHPA A, B or C please attach relevant information and approved mitigation measures from the Risk Manager Official.

5. Are any of the following uses or features on the subject lands or within 500 metres of the subject lands, unless otherwise specified? Please check boxes, if applicable.

Livestock facility or stockyard (submit MDS Calculation with application)

☐ On the subject lands or ☐ within 500 meters – distance _____

Wooded area

☒ On the subject lands or ☐ within 500 meters – distance abutting

Municipal Landfill

☐ On the subject lands or ☐ within 500 meters – distance _____

Sewage treatment plant or waste stabilization plant

☐ On the subject lands or ☐ within 500 meters – distance _____

Provincially significant wetland (class 1, 2 or 3) or other environmental feature

☒ On the subject lands or ☐ within 500 meters – distance _____

Floodplain

☐ On the subject lands or ☐ within 500 meters – distance _____

Rehabilitated mine site

☐ On the subject lands or ☐ within 500 meters – distance _____

Non-operating mine site within one kilometre

☐ On the subject lands or ☐ within 500 meters – distance _____

Active mine site within one kilometre

☐ On the subject lands or ☐ within 500 meters – distance _____

Industrial or commercial use (specify the use(s))

☒ On the subject lands or ☐ within 500 meters – distance abutting

Active railway line

☐ On the subject lands or ☐ within 500 meters – distance _____

Seasonal wetness of lands

☐ On the subject lands or ☐ within 500 meters – distance _____

Erosion

☐ On the subject lands or ☐ within 500 meters – distance _____

Abandoned gas wells

☐ On the subject lands or ☐ within 500 meters – distance _____

F. Servicing and Access

1. Indicate what services are available or proposed:

Water Supply

- ☒ Municipal piped water
 - ☐ Communal wells
 - ☐ Individual wells
 - ☐ Other (describe below)
-

Sewage Treatment

- ☒ Municipal sewers
 - ☐ Communal system
 - ☒ Septic tank and tile bed
 - ☐ Other (describe below)
-

Storm Drainage

- ☐ Storm sewers
 - ☐ Open ditches
 - ☐ Other (describe below)
-

2. Have you consulted with Public Works & Environmental Services concerning storm water management?

☐ Yes ☒ No

3. Has the existing drainage on the subject lands been altered?

☐ Yes ☒ No

4. Does a legal and adequate outlet for storm drainage exist?

☐ Yes ☐ No

5. How many water meters are required? NONE

6. Existing or proposed access to subject lands:

- ☒ Municipal road
- ☐ Provincial highway
- ☐ Unopened road
- ☐ Other (describe below)

7. Name of road/street:

Queensway West, Simcoe, ON

G. Other Information

1. Does the application involve a local business? ☐ Yes ☒ No

If yes, how many people are employed on the subject lands?

2. Is there any other information that you think may be useful in the review of this application? If so, explain below or attach on a separate page.

N/A

H. Supporting Material to be submitted by Applicant

In order for your application to be considered complete, folded hard copies (number of paper copies as directed by the planner) and an **electronic version (PDF) of the site plan drawings, additional plans, studies and reports** will be required, including but not limited to the following details:

1. Concept/Layout Plan
2. All measurements in metric
3. Key map
4. Scale, legend and north arrow
5. Legal description and municipal address
6. Development name
7. Drawing title, number, original date and revision dates
8. Owner's name, address and telephone number
9. Engineer's name, address and telephone number
10. Existing and proposed easements and right of ways
11. Zoning compliance table – required versus proposed
12. Parking space totals – required and proposed
13. Loading spaces, facilities and routes
14. All dimensions of the subject lands
15. Dimensions and setbacks of all buildings and structures
16. Gross, ground and useable floor area
17. Lot coverage
18. Floor area ratio
19. Building entrances and grades
20. Names of adjacent streets
21. Driveways, curbs, drop curbs, pavement markings, widths, radii and traffic directional signs
22. Fire access and routes
23. Location, dimensions and number of parking spaces (including visitor and accessible) and aisles
24. Location of mechanical room
25. Refuse disposal and storage areas including any related screening
26. Winter snow storage location
27. Landscape areas with dimensions
28. Natural features, watercourses and trees
29. Fire hydrants and utilities location
30. Fencing, screening and buffering – size, type and location
31. All hard surface materials
32. Light standards and wall mounted lights

33. Signs
34. Sidewalks and walkways with dimensions
35. Pedestrian access routes into site and around site
36. Bicycle parking
37. Professional engineer's stamp

In addition, the following additional plans, studies and reports, including but not limited to, **may** also be required as part of the complete application submission:

- ☐ Zoning Deficiency Form
- ☐ On-Site Sewage Disposal System Evaluation Form
- ☐ Architectural Plan
- ☐ Buildings Elevation Plan
- ☐ Cut and Fill Plan
- ☐ Erosion and Sediment Control Plan
- ☐ Grading and Drainage Control Plan (around perimeter and within site) (existing and proposed)
- ☐ Landscape Plan
- ☐ Photometric (Lighting) Plan
- ☐ Plan and Profile Drawings
- ☐ Site Servicing Plan
- ☐ Storm water Management Plan
- ☐ Street Sign and Traffic Plan
- ☐ Street Tree Planting Plan
- ☐ Tree Preservation Plan
- ☐ Archaeological Assessment
- ☐ Environmental Impact Study
- ☐ Functional Servicing Report
- ☐ Geotechnical Study / Hydrogeological Review
- ☐ Minimum Distance Separation Schedule
- ☐ Noise or Vibration Study
- ☐ Record of Site Condition
- ☐ Storm water Management Report

- ☐ Traffic Impact Study – please contact the Planner to verify the scope of the study required

Your development approval might also be dependent on Ministry of Environment and Climate Change, Ministry of Transportation or other relevant federal or provincial legislation, municipal by-laws or other agency approvals.

All final plans must include the owner's signature as well as the engineer's signature and seal.

I. Development Agreements

A development agreement may be required prior to approval for site plan, subdivision and condominium applications. Should this be necessary for your development, you will be contacted by the agreement administrator with further details of the requirements including but not limited to insurance coverage, professional liability for your engineer, additional fees and securities.

J. Transfers, Easements and Postponement of Interest

The owner acknowledges and agrees that if required it is their solicitor's responsibility on behalf of the owner for the registration of all transfer(s) of land to the County, and/or transfer(s) of easement in favour of the County and/or utilities. Also, the owner further acknowledges and agrees that it is their solicitor's responsibility on behalf of the owner for the registration of postponements of any charges in favour of the County.

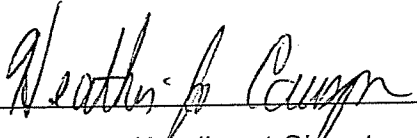

Owner/Applicant Signature



Date

K. Permission to Enter Subject Lands

Permission is hereby granted to Norfolk County officers, employees or agents, to enter the premises subject to this application for the purposes of making inspections associated with this application, during normal and reasonable working hours.

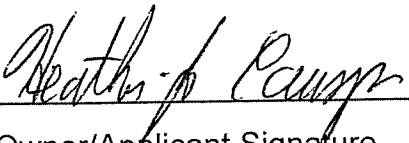

Owner/Applicant Signature

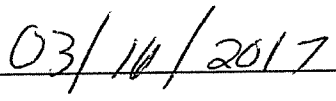

Date



L. Freedom of Information

For the purposes of the *Municipal Freedom of Information and Protection of Privacy Act*, I authorize and consent to the use by or the disclosure to any person or public body any information that is collected under the authority of the *Planning Act*, R.S.O. 1990, c. P. 13 for the purposes of processing this application.

Heather Jo Causyn
Owner/Applicant Signature

03/16/2017
Date

M. Endangered Species Act, 2007

Endangered and threatened species and their habitat are protected under the provinces Endangered Species Act, 2007. The Act prohibits development or site alteration within areas of significant habitat for endangered or threatened species without demonstrating that no negative impacts will occur. The Ministry of Natural Resources (MNR), Aylmer District provides the service of responding to species at risk information requests and project screenings. The applicant has been directed to discuss the proposed activity and have their project screened with MNR. Please be advised that it is owner's responsibility to be aware of and comply with all relevant federal or provincial legislation, municipal by-laws or other agency approvals.

Heather Jo Causyn
Owner/Applicant Signature

03/16/2017
Date

N. Owner's Authorization

If the applicant/agent is not the registered owner of the lands that is the subject of this application, the owner must complete the authorization set out below.

I/We Heather Jo Causyn am/are the registered owner(s) of the lands that is the subject of this application for development approval.

I/We authorize Tom Cline to make this application on my/our behalf and to provide any of my/our personal information necessary for the processing of this application. Moreover, this shall be your good and sufficient authorization for so doing.

Heather Jo Causyn
Owner

03/16/2017
Date

Owner

Date



O. Declaration of Applicant and Agent

I hereby apply for development approval and declare that all of the above statements and the statements contained in all of the exhibits transmitted herewith are accurate and true. I understand that development approval is required before a building permit can be issued.

Applicant Signature

Date

Agent Signature

Date

P. Declaration

I, Heather Jo Causyn of Norfolk County

solemnly declare that:

all of the above statements and the statements contained in all of the exhibits transmitted herewith are true and I make this solemn declaration conscientiously believing it to be true and knowing that it is of the same force and effect as if made under oath and by virtue of *The Canada Evidence Act*.

Declared before me at:

Norfolk County

Owner/Applicant Signature

In Province of Ontario

This 15th day of March

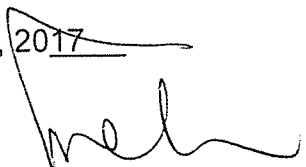
A.D., 2017

A Commissioner, etc.



SKETCH FOR
SEVERANCE APPLICATION
OF PART OF
LOT 3, CONCESSION 14
IN THE GEOGRAPHIC
TOWNSHIP OF WINDHAM
IN
NORFOLK COUNTY
SCALE: 1 : 750
JEWITT AND DIXON LTD.
MARCH 7, 2017

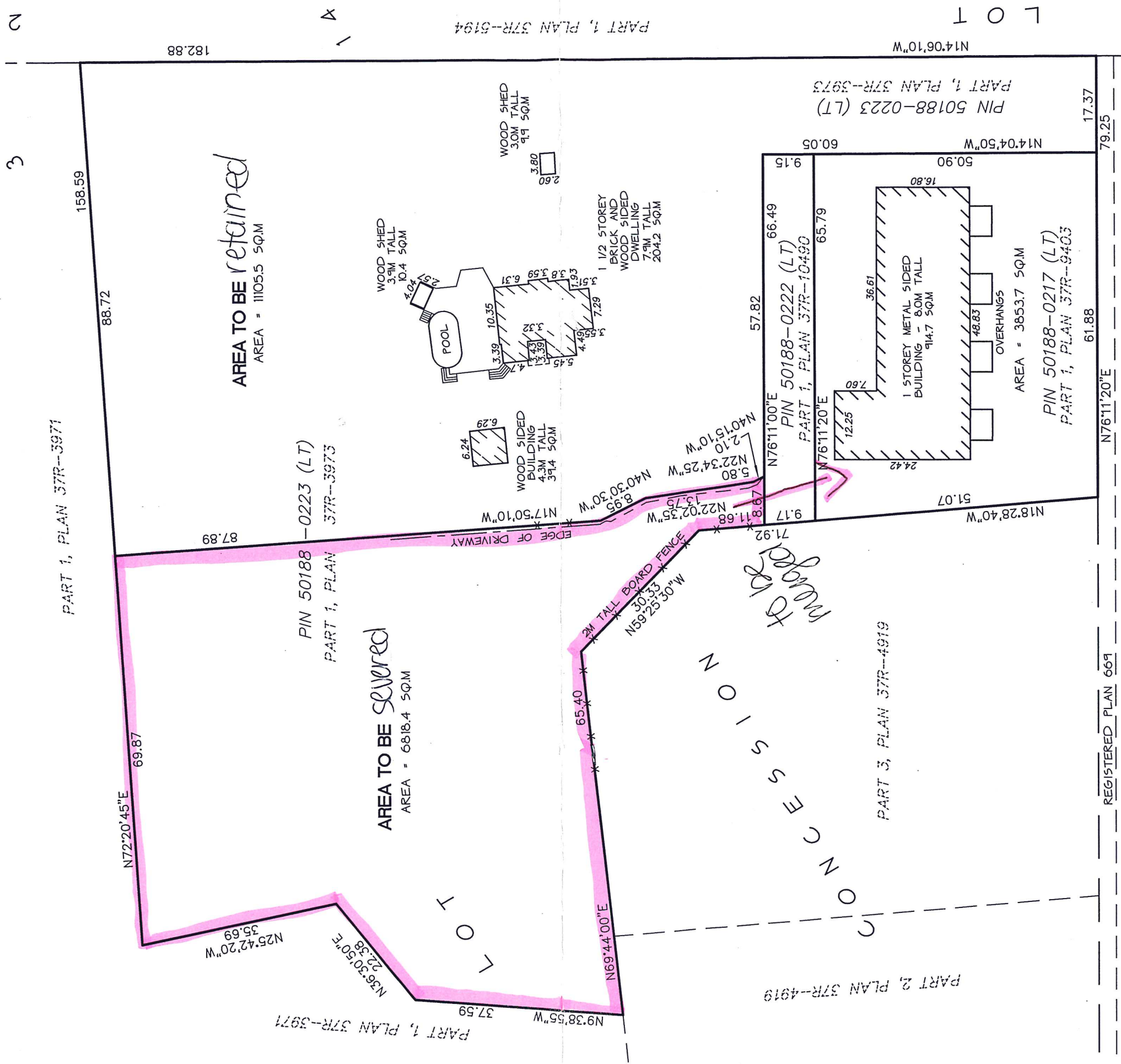

THE KING'S HIGHWAY NO. 3
(AS WIDENED BY REGISTERED PLAN 669)

NOTE:

THIS PLAN IS IN METRIC AND CAN BE CONVERTED
TO IMPERIAL BY MULTIPLYING BY 3.2808

CAUTION:

THIS IS NOT A PLAN OF SURVEY AND SHALL NOT
BE USED FOR PURPOSES OTHER THAN THE
PURPOSE INDICATED IN THE TITLE BLOCK.

JEWITT AND DIXON LTD.
ONTARIO LAND SURVEYORS
R.R.1, SIMCOE, ONTARIO, N3Y 4J9
(51 PARK ROAD)

PHONE: (519) 426-0842 FAX: (519) 426-1034
E-mail: surveyors@amtelecom.net

MAP 1

File Number: BNPL2017121

Urban Area of
SIMCOE

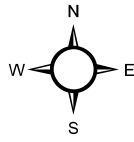

1:2,000

10 5 0 10 20 30 40
Meters

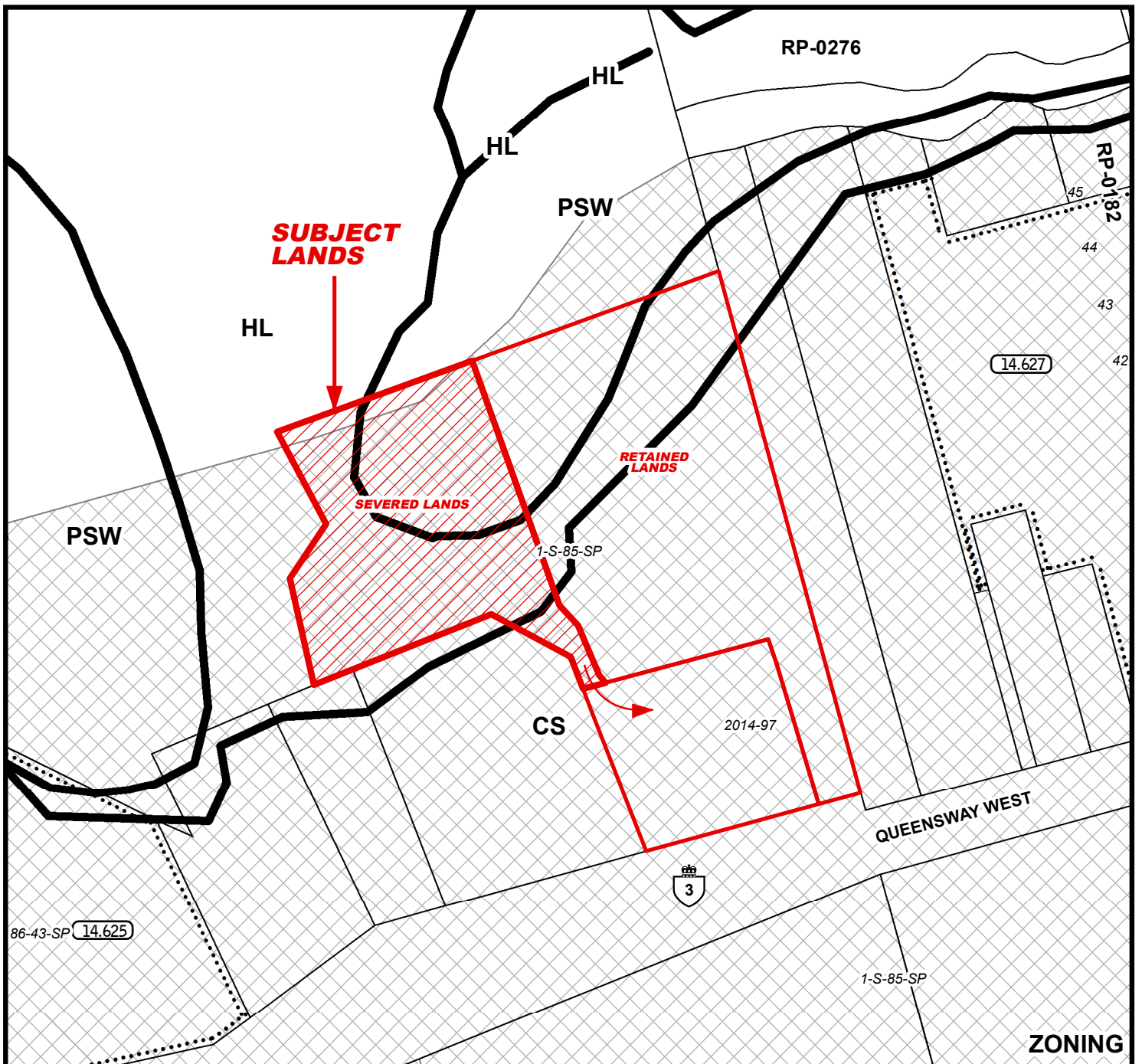
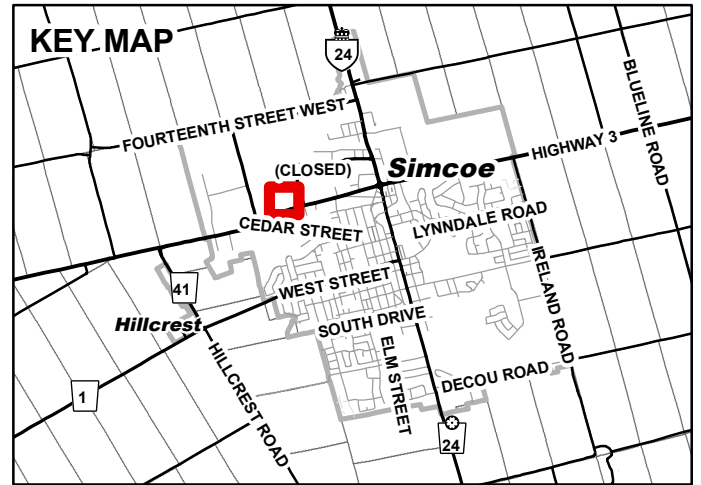

ZONING

6/28/2017

MAP 2

File Number: BNPL2017121

Urban Area of SIMCOE

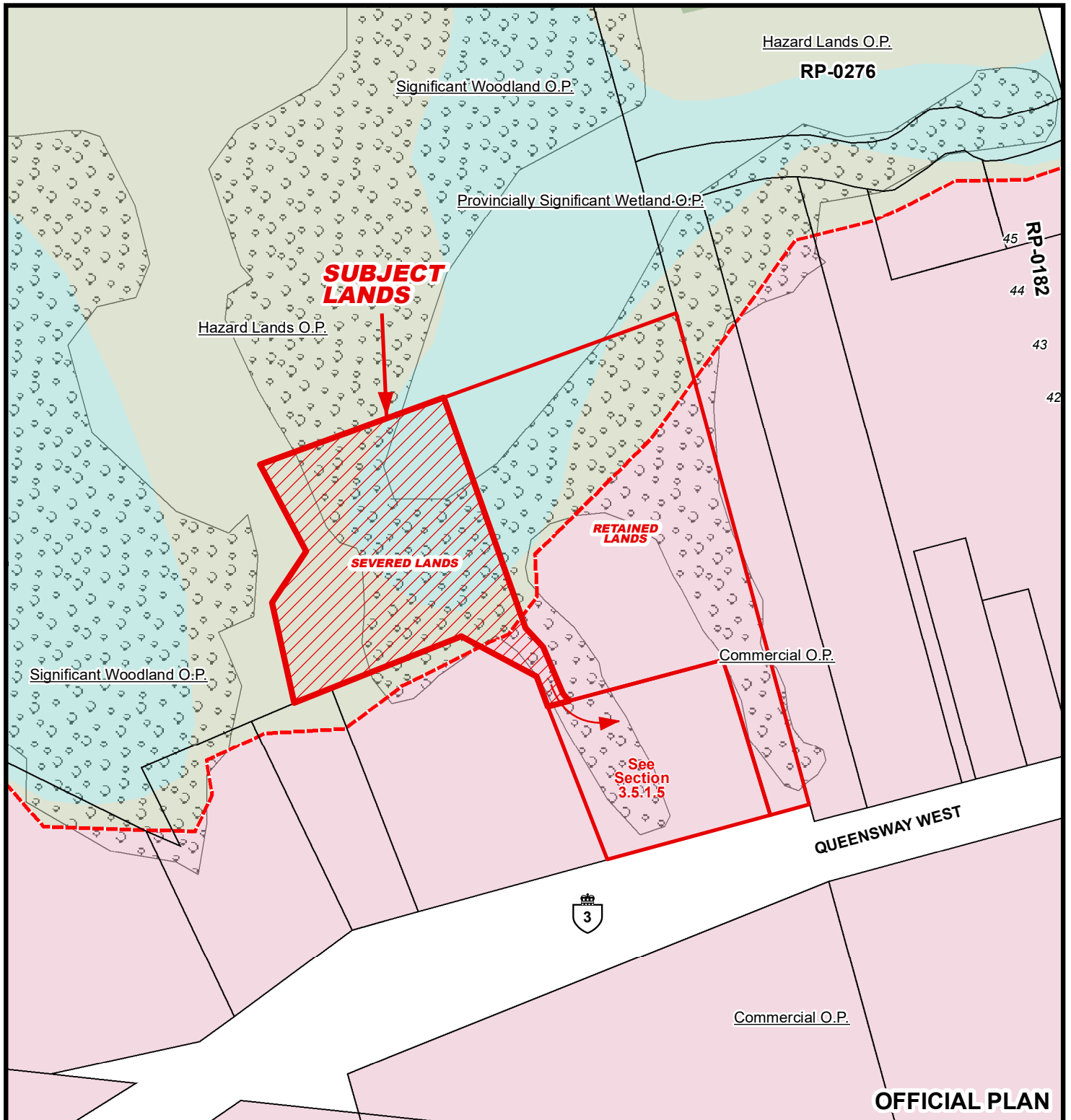
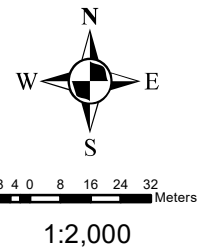

MAP 3

File Number: BNPL2017121

Urban Area of SIMCOE

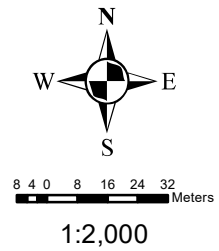

MAP 4

File Number: BNPL2017121

Urban Area of SIMCOE

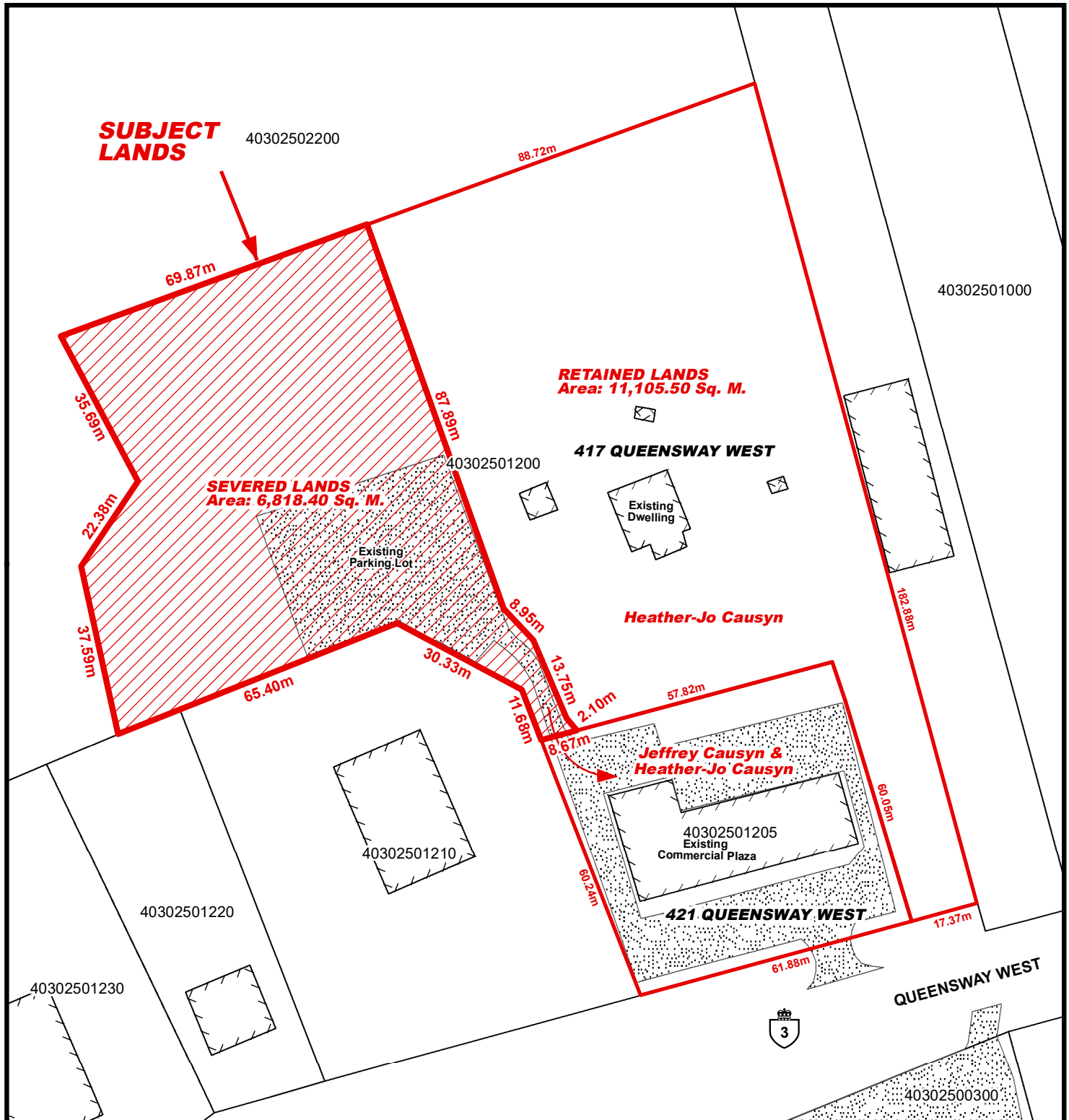
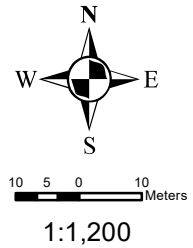

LOCATION OF LANDS AFFECTED

File Number: BNPL2017121

Urban Area of SIMCOE

