



**THE CORPORATION OF NORFOLK COUNTY
COMMITTEE OF ADJUSTMENT**

COMMENT REQUEST FORM

This Committee has received a consent/minor variance application concerning land within your jurisdiction. The proposal is explained on the attached application. If you require further information, please feel free to contact this office.

In order to properly consider this application, the Committee of Adjustment would appreciate your comments or recommendation before the date below:

September 12TH, 2007

FILE NO.: BN-062-2007

ASSESSMENT ROLL NO.: 3310-334-010-027

APPLICANT:

Bernice Borr, 2011 Maple Blvd, Port Dover ON N0A 1N2

AGENT:

N/A, ,

LOCATION:

Lot 34-35 Plan 37 R 2233 PTDOV (2011 Maple Blvd, Port Dover)

PROPOSAL:

Sever a parcel having a frontage of 13.37 m. (43.86 ft.) a depth of 44.83 m. (147 ft.) and having an area of 600 m². (1968.5 ft²) and retain a parcel having an area of 683 m² (2241.ft²) more or less as a boundary adjustment.

- | | |
|--|---|
| <input checked="" type="checkbox"/> Building Department | <input checked="" type="checkbox"/> GIS Section |
| <input checked="" type="checkbox"/> Building Inspector (Sewage System Review) | <input type="checkbox"/> Norfolk Power |
| <input checked="" type="checkbox"/> Forestry Division | <input type="checkbox"/> Ministry of Transportation |
| <input checked="" type="checkbox"/> Treasury Department | <input type="checkbox"/> Railway |
| <input checked="" type="checkbox"/> Public Works > NOTE: If an agreement is required please attach the clauses you require in the agreement. | <input type="checkbox"/> Conservation Authority |

CIRCULATION DATE: August 29th, 2007

PLEASE REPLY BY FAX OR EMAIL DIRECTLY TO:

Shirley Cater, MCIP, RPP

Norfolk County, 60 Colborne Street, South, Simcoe, ON N3Y 4N5

(519) 426-5870 ext 1290

FAX: (519) 428-3069 EMAIL: shirley.cater@norfolkcounty.ca

COMMITTEE OF ADJUSTMENT DECISION:

If you wish to be notified of the Decision of Norfolk County, Committee of Adjustment in respect of the proposed consent, you must make a written request to: Larry Dawson, Acting Secretary-Treasurer, P.O. Box 128, 22 Albert Street, Langton ON N0E 1G0 • Phone: (519) 875-4485 ext 1835; Fax: (519) 875-4789; Email: larry.dawson@norfolkcounty.ca

APPEALS TO THE ONTARIO MUNICIPAL BOARD:

If a person or public body that files an appeal of a Decision of Norfolk County Committee of Adjustment in respect of the proposed consent or variance does not make written submission to the Norfolk County Committee of Adjustment, before it gives or refuses to give a provisional consent or variance, the Ontario Municipal Board may dismiss the appeal.

CONSENT / SEVERANCE

Office Use:

File Number: BN-62/07
 Related File: AN-47/07
 Fees Submitted: A Aug. 17/07
 Application Submitted: Aug 17/07
 Sign Issued: " *AB*
 Complete Application: "

This development application must be typed or printed in ink and completed in full. An incomplete or improperly prepared application may not be accepted and could result in processing delays.

Property assessment roll number: 3310- 334-010-027

- Creation of a new lot
- Boundary adjustment
- Easement/right-of-way
- Other (lease / charge)

A. APPLICANT INFORMATION

Name of Applicant ¹ BERNICE BARR Phone # 519-583-1107
 Address 2011 MAPLE BLVD Fax #
 Town / Postal Code PORT DOVER ONT E-mail NOAINZ

¹ If the applicant is a numbered company provide the name of a principal of the company.

Name of Agent _____ Phone # _____
 Address _____ Fax # _____
 Town / Postal Code _____ E-mail _____

Name of Owner ² _____ Phone # _____
 Address _____ Fax # _____
 Town / Postal Code _____ E-mail _____

² It is the responsibility of the owner or applicant to notify the Planner of any changes in ownership within 30 days of such a change.

Please specify to whom all communications should be sent ³: Applicant Agent Owner

³ Unless otherwise directed, all correspondence, notices, etc., in respect of this development application will be forwarded to the Applicant noted above, except where an Agent is employed, then such will be forwarded to the Applicant and Agent.

Names and addresses of any holders of any mortgagees, charges or other encumbrances on the subject lands:



CONSENT / SEVERANCE

B. LOCATION/LEGAL DESCRIPTION OF SUBJECT LANDS

Geographic Township	_____	Urban Area or Hamlet	<u>PORT DOVER</u>
Concession Number	_____	Lot Number(s)	<u>34 - 35</u>
Registered Plan Number	_____	Lot(s) or Block Number(s)	_____
Reference Plan Number	<u>37 R 2233</u>	Part Number(s)	_____
Frontage (metres/feet)	_____	Depth (metres/feet)	_____
Width (metres/feet)	_____	Lot area (m ² / ft ² or hectares/acres)	_____
Municipal Civic Address	<u>2011 MAPLE BLVD PORT DOVER</u>		

For questions regarding requirements for a municipal civic address please contact NorfolkGIS@norfolkcounty.on.ca.

To obtain your municipal civic address for the severed lands please contact your local building inspector.

Are there any easements or restrictive covenants affecting the subject lands?

Yes No

If yes, describe the easement or covenant and its effect:

ROW TO BEACH

C. PURPOSE OF DEVELOPMENT APPLICATION

Please explain what you propose to do on the subject lands/premises which makes this development application necessary (if additional space is required, please attach a separate sheet):

TO SEVER A LOT WITHIN URBAN AREA

Name of person(s), if known, to whom lands or interest in lands is to be transferred, leased or charged (if known):

UNKNOWN

If a boundary adjustment, identify the **assessment roll number** and **property owner** of the lands to which the parcel will be added:

CONSENT / SEVERANCE

If the application involves the severance of a surplus farmhouse (through farm amalgamation), please list all properties in Norfolk County, which are owned and farmed by the applicant and involved in the farm operation:

Owners Name and Address <small>(including those with part interest)</small>	Geographic Township	Total Acreage <small>(individual property)</small>	Acres Workable <small>(individual property)</small>	Existing Farm Type <small>(individual property e.g. corn production, orchard, tobacco)</small>	Dwelling Present	Year Dwelling Built
Assessment Roll No. <small>(obtained from your tax bill)</small>	Concession and Lot #					
SUBJECT LANDS					<input type="checkbox"/> Yes	<input type="checkbox"/> No
OTHER					<input type="checkbox"/> Yes	<input type="checkbox"/> No
					<input type="checkbox"/> Yes	<input type="checkbox"/> No
					<input type="checkbox"/> Yes	<input type="checkbox"/> No
					<input type="checkbox"/> Yes	<input type="checkbox"/> No
					<input type="checkbox"/> Yes	<input type="checkbox"/> No
					<input type="checkbox"/> Yes	<input type="checkbox"/> No

If the application proposes to divide a farm into two smaller agricultural parcels, please complete the following:

Description of Land	Lands to be Severed	Lands to be Retained
Area under cultivation	(m ² / ft ² or hectares/acres)	(m ² / ft ² or hectares/acres)
Woodlot area	(m ² / ft ² or hectares/acres)	(m ² / ft ² or hectares/acres)
Existing crops grown (type and area)		
Proposed crops grown (type and area)		

Description of Existing Buildings	Lands to be Severed	Lands to be Retained
Residence	<input type="checkbox"/> Yes <input type="checkbox"/> No	<input type="checkbox"/> Yes <input type="checkbox"/> No
Livestock barn	<input type="checkbox"/> Yes <input type="checkbox"/> No	<input type="checkbox"/> Yes <input type="checkbox"/> No
Type of livestock		
Capacity of barn		
Manure storage	<input type="checkbox"/> Yes <input type="checkbox"/> No	<input type="checkbox"/> Yes <input type="checkbox"/> No
Type of manure storage		

CONSENT / SEVERANCE

Description of land intended to be **SEVERED**:

Frontage (metres/feet) 13.37 M / 43.86 Depth (metres/feet) 44.83 / 147
Width (metres/feet) _____ Lot area (m² / ft² or hectares/acres) 600 M²

Existing use: RES

Proposed use: RES

Number and type of buildings and structures existing on the land to be severed, please describe in metric units, the setback from the front lot line, rear lot line and side lot lines, the height of the building or structure and its dimensions or floor area:
2 SHEDS TO BE REMOVED

Number and type of buildings and structures proposed on the land to be severed, please describe in metric units, the setback from the front lot line, rear lot line and side lot lines, the height of the building or structure and its dimensions or floor area:
UNKNOWN

Description of land intended to be **RETAINED**:

Frontage (metres/feet) 15.24 / 50 Depth (metres/feet) 44.83 / 147
Width (metres/feet) _____ Lot area (m² / ft² or hectares/acres) 683 M²

Existing use: RES

Proposed use: SAME

Number and type of buildings and structures existing on the land to be retained, please describe in metric units, the setback from the front lot line, rear lot line and side lot lines, the height of the building or structure and its dimensions or floor area:
HOUSE

Number and type of buildings and structures proposed on the land to be retained, please describe in metric units, the setback from the front lot line, rear lot line and side lot lines, the height of the building or structure and its dimensions or floor area:
SAME

CONSENT / SEVERANCE

If this application proposes to sever a dwelling made surplus through farm amalgamation, when were the farm properties amalgamated?

Date of construction of the dwelling proposed to be severed:

Date of purchase of subject lands:

E. PREVIOUS USE OF THE PROPERTY

Has there been an industrial or commercial use on the subject lands or adjacent lands?

Yes No Unknown

If yes, specify the uses:

Has the grading of the subject lands been changed through excavation or the addition of earth or other material?

Yes No Unknown

Has a gas station been located on the subject lands or adjacent lands at any time?

Yes No Unknown

Has there been petroleum or other fuel stored on the subject lands or adjacent lands at any time?

Yes No Unknown

Is there reason to believe the subject lands may have been contaminated by former uses on the site or adjacent sites?

Yes No Unknown

Provide the information you used to determine the answers to the above questions:

PERSONAL KNOWLEDGE

If you answered yes to any of the above questions, a previous use inventory showing all known former uses of the subject lands, or if appropriate, the adjacent lands, is needed.

Is the previous use inventory attached?

Yes No

CONSENT / SEVERANCE

F. STATUS OF OTHER PLANNING DEVELOPMENT APPLICATIONS

Has the subject land or land within 120 metres of it been or is now the subject of an application under the *Planning Act, R.S.O. 1990, c. P. 13* for:

- (a) a minor variance or a consent;
- (b) an amendment to an official plan, a zoning by-law or a Minister's zoning order; or
- (c) approval of a plan of subdivision or a site plan?

Yes No Unknown

If yes, indicate the following information about **each application**:

File number: AN-47/07

Land it affects: LOT 34

Purpose: RELIEF FROM FRONTAGE

Status/decision: SUBMITTED AT SAME TIME

Effect on the requested amendment:

If additional space is required, please attach a separate sheet.

Is the above information for other planning developments applications attached?

Yes No

G. PROVINCIAL POLICY

Is the requested application consistent with the provincial policy statements issued under subsection 3(1) of the *Planning Act, R.S.O. 1990, c. P. 13*?

Yes No

If no, please explain:

Are the subject lands within an area of land designated under any provincial plan or plans?

Yes No

If yes, does the requested application conform to or does not conflict with the provincial plan or plans:

MAP 1

File Number: BN-062/2007 & AN-047/2007

Urban Area of PORT DOVER



Lake Erie

MAP 2

File Number: BN-062/2007 & AN-047/2007

Urban Area of Port Dover

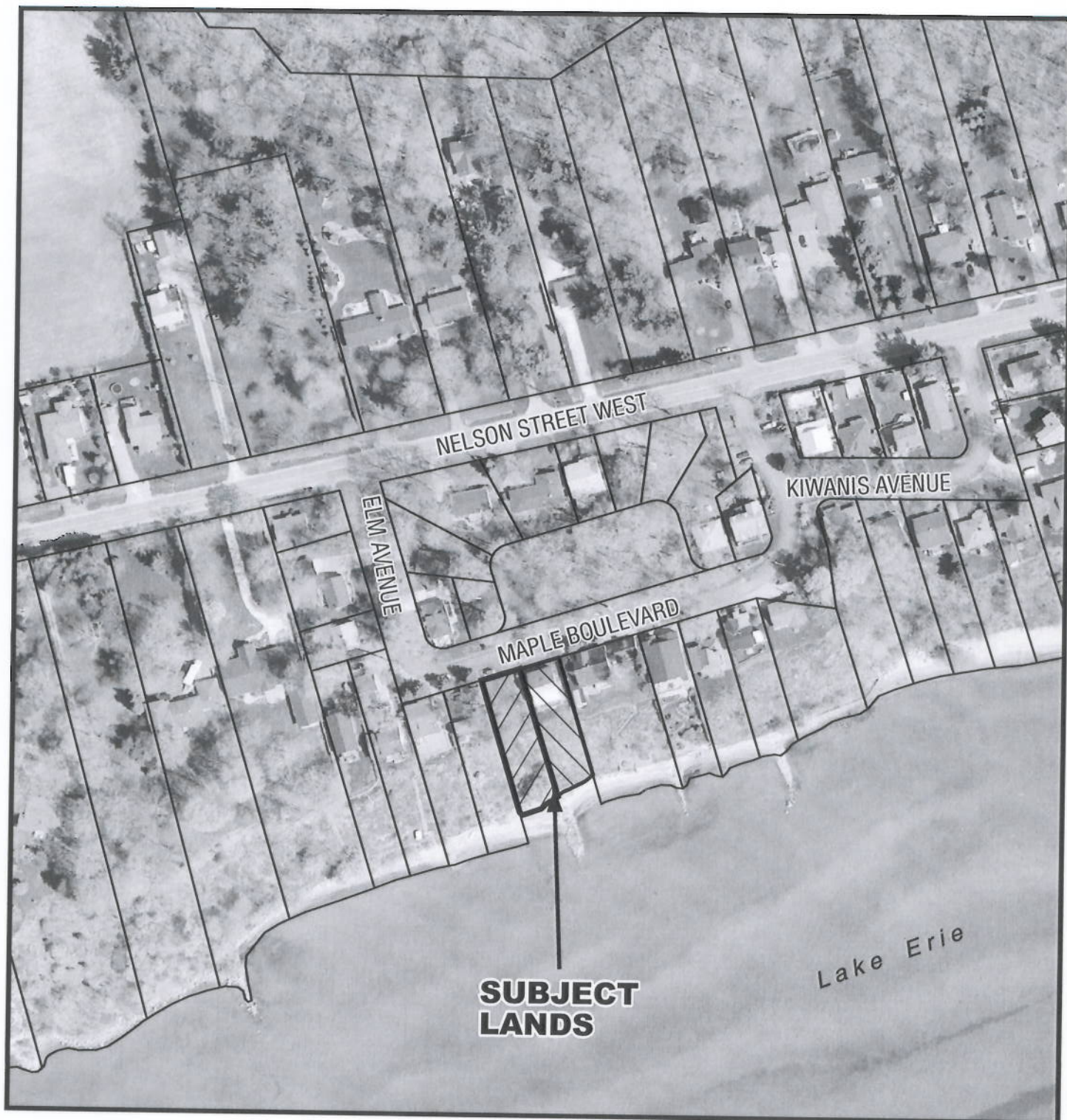
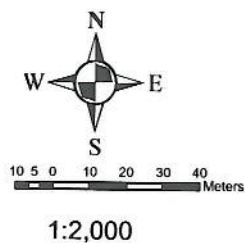

MAP 3

File Number: BN-062/2007 & AN-047/2007

Urban Area of Port Dover

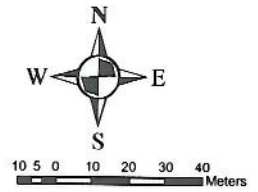

1:2,000

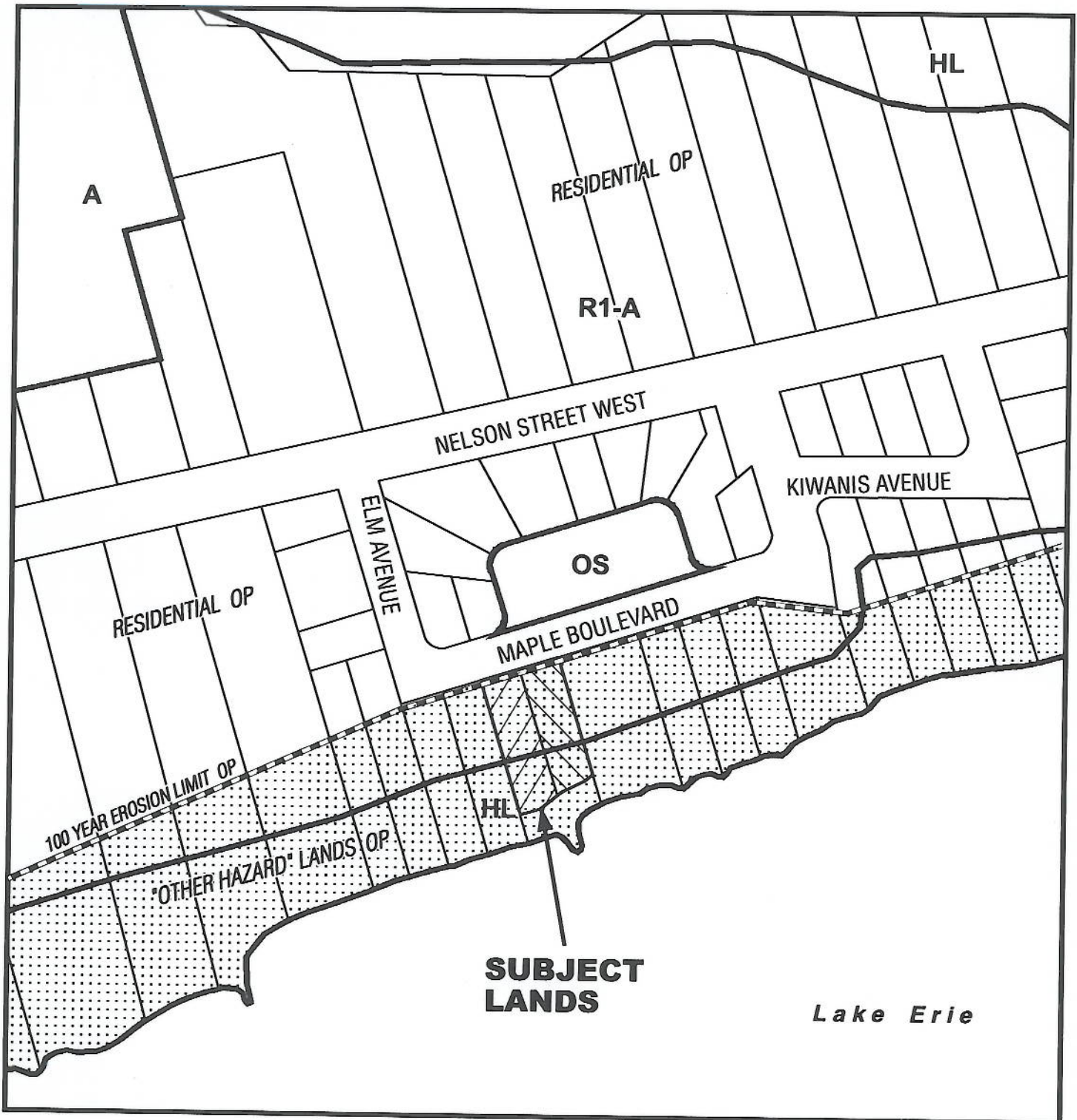

MAP 4

File Number: BN-062/2007 & AN-047/2007

Urban Area of Port Dover



3 1.5 0 3 6 9 12 Meters

1:500

